



3500 lbs. ATV/UTV Winch

Owner's Manual



Congratulations on your purchase. You have purchased a dependable and sturdy Winch but only by proper care and operation can you expect to receive the service and long life designed and built into it. This manual contains valuable information about your new Winch. It has been carefully prepared to give you helpful suggestions for operating, adjusting, servicing and ordering repair parts.

#EW3500DLX

BLANK

Keep this manual in a convenient place for quick and easy reference. Study it carefully. If in the future your seeder may need new parts to replace those that are worn or broken, if so, call 1 (800)333-8889 and provide the model, part number, and proof of purchase and we will replace the part as outlined in our Limited Warranty.

WARNINGS

It is the purchaser and/or operator's responsibility to:

- ▲ Read, study and follow all instructions before operating this device. Failure to heed these instructions may result in personal injury and/or property damage.
- ▲ Operate, lubricate, assemble and maintain the equipment in accordance with all instructions and safety procedures in this manual.
- ▲ Inspect the equipment and replace or repair any parts that are damaged or worn which under continued operation would cause damage, wear to other parts, or cause a safety hazard.
- ▲ Your winch can develop tremendous pulling forces and if used unsafely or improperly could result in property damage, serious injury or death

Important Safety Information

THE FOLLOWING SAFETY RECOMMENDATIONS ARE TO SAFEGUARD YOU THEREFORE IT IS NECESSARY TO READ THEM CAREFULLY, MEMORIZING AND ALWAYS APPLYING THEM.

The warnings in this manual regard exclusively the allowed uses and reasonably foreseeable. All below Instructions must be used with common sense and adequate measures to prevent accidents.

The machine must be used by an experienced, of age operator.

All the listed instructions must be carefully respected.

Possible changes to the machine, not authorized by the manufacturer (by written copy), exclude his responsibility.

Check for correct functioning of the machine, before every use.

Carefully read this manual before proceeding to start, operate, employ or maintenance the machine.

Watch, in addition to the warnings of this manual, all the safety, accident prevention rules of general nature.

The manual must always be handy, so as to consult it, in order to check working cycle and safety information. In case of loss or damage, it will be necessary to ask for a replacement copy.

Pay particular attention to the notes preceded by these symbols as they are written for your safety. Ultimately, safe operation of this device rests with you, the operator.



CAUTION

Indicates a potentially hazardous situation which, if not avoided, may result in minor or moderate injury. This notation is also used to alert against unsafe practices.



WARNING

Indicates a potentially hazardous situation which, if not avoided could result in death or serious injury.

▲ WARNING – DO NOT EXCEED RATED CAPACITY.

▲ WARNING – Intermittent use only.

▲ WARNING - Do not use winch in lifting or moving or persons.

⚠ WARNING - A minimum of five wraps of cable around the drum barrel is necessary for pulling and holding the rated load. The cable clamp is not designed to hold the load without 5 wraps of cable around the barrel.

⚠ WARNING - Keep yourself and others a safe distance to the side of the cable when under tension.

⚠ WARNING - The wire rope may break before the motor stalls. For heavy loads at or near rated capacity, use a pulley block/snatch block to reduce the load on the wire rope.

⚠ WARNING - Never step over a cable, or near a cable under load.

⚠ WARNING - Don't move the vehicle to pull a load (towing) on the winch cable. This could result in cable breakage.

⚠ WARNING - Disconnect the remote control and battery leads when not in use.

⚠ WARNING - Do not exceed maximum pull rating. Avoid "shock loads" by using the control switch intermittently to take up the slack in the wire rope. "Shock loads" can far exceed the rate capacity for the wire rope and drum.

⚠ WARNING - Do not exceed maximum line pull ratings shown on the tables.

⚠ WARNING - When re-spooling the cable, ensure that the cable spools in the under-wind position with the cable entering the drum from the bottom, not the top. To re-spool correctly, and while wearing gloves, keep a slight load on the cable while pushing the remote button to draw in the cable. Walk toward the winch not allowing the cable to slide through your hands. Do not let your hands get within 12" of the winch while re-spooling. Turn off the winch and repeat the procedure until a few feet of cable is left. Disconnect the remote control and finish spooling by hand by rotating the drum by hand with the clutch disengaged. Keep hands clear of the fairlead and drum while the winch is under power. Do not use as a hoist. Do not use for overhead lifting. Failure to heed these warnings may result in personal injury and/or property damage.

⚠ WARNING - Use gloves to protect hands when handling the cable. Never let the cable slide through your hands.

⚠ WARNING - Never connect the cable back to itself. Apply blocks to the wheels of the vehicle when on an incline.

No modifications, alterations, or deviation to the winch are authorized by the manufacturer and SHALL not be made.

Duration of winching pulls should be kept as short as possible. If the motor becomes uncomfortably hot to the touch, stop winching immediately and let it cool down for a few minutes. Do not pull for more than one minute at or near the rated load.

⚠ CAUTION - If the motor stalls do not maintain power to the winch. Electric winches are designed and made of intermittent use and should not be used in constant duty applications.

⚠ CAUTION - Never release the free-spool clutch when there is a load on the winch.

⚠ CAUTION - Use hand saver hook when handling the hook for spooling or un-spooling the wire rope.

GENERAL TIPS FOR SAFE OPERATION

- ▶ The winch is rated at 3500 lbs capacity when spooling the first rope layer on the drum. Overloads can damage the winch/motor/ or wire rope. For loads over 1800 lbs. we recommend the use of the pulley block/snatch block to double the wire rope line. It will aid in two ways: a) reduce the number or rope layers on the drum, as well as, b) reduce the load on the wire rope by as much as 50%. When doubling the line back to the vehicle, attach to the frame or other load bearing part.
- ▶ The vehicle engine should be kept running during operation of the winch to minimize battery drain and maximize power and speed of the winch. If the winch is used for a considerable time with the engine off the battery may be drained and too weak to restart the engine

- ▲ Get to know your winch before you actually need to use it. We recommend that you set up a few test runs to familiarize yourself with rigging techniques, the sounds your winch makes under various loads, the way the cable spools on the drum, etc.
- ▲ Inspect the wire rope and equipment before each use. A frayed or damaged rope shall be replaced immediately. Use only manufacturer's identical replacement rope with the exact specifications.
- ▲ Inspect the winch installation and bolts to ensure that all bolts are tight before each operation.
- ▲ Never connect the cable back to itself. This will cause cable damage. Always use a snatch block, sling or chain of suitable strength.
Store the remote control inside your vehicle in a place that it will not be damaged.
- ▲ Any winch that appears to be damaged in any way, is found to be worn, or operates abnormally SHALL BE REMOVED FROM SERVICE UNTIL REPAIRED. It is recommended that the necessary repairs be made by a manufacturer's authorized repair facility.
- ▲ Pull only on areas of the vehicle as specified by the vehicle manufacturer.
Only attachments and/or adapters supplied by the manufacturer shall be used.

GETTING TO KNOW YOUR WINCH

Your 3500lb winch is a powerful piece of machinery. It is important that you understand the basics of its operation and specifications so that when you need to use it, you can use it with confidence and safety. Below is a list of the components of your winch and their use. Practice using your winch before you are in a situation where you need to use it.

- ▲ **Motor:** Your 1.3hp motor is powered by a 12 volt battery and provides power to the gear mechanism which turns the drum and winds the wire rope;
- ▲ **Winch Drum:** The winch drum is the cylinder on which the wire rope is stored. It can feed or wind the rope depending on the remote winch switch.
- ▲ **Wire Rope:** Your winch has a 7/32"X42" galvanized aircraft cable designed specifically for load capacity of 3500lbs. The wire rope feeds onto the drum in the "under wind" position through the roller fairlead and is looped at the end to accept the clevis hook pin.
- ▲ **Roller Fairlead:** When using the winch at an angle the roller fairlead acts to guide the wire rope onto the drum and minimizes damage to the wire rope from abrasion on the winch mount or bumper.
- ▲ **Mechanic Gear System:** The reduction gears convert the winch motor power into extreme pulling forces.
- ▲ **Braking System:** Braking action is automatically applied to the winch drum when the winch motor is stopped and there is a load on the wire rope. The braking action is applied by a separate mechanical brake.
- ▲ **Free Spooling Clutch:** The clutch allows the operator to manually disengage ("Out") the spooling drum from the gear train, free spool. Engaging the clutch ("In") locks the winch into the gear system.
- ▲ **Control System:** your winch has multiform operations for a variety of applications, you can directly control your winch by using Power Cord/Switch Assembly, you can also control your winch through a solenoid control box by pressing a button on the power switch you selected to use.
- ▲ **Solenoid:** Power from the vehicle battery flows through the weather sealed switch before being directed to the winch motor.
- ▲ **Remote Switch:** The Power switch leads has a dual switch for powering in or powering out your winch drum. The Power switch leads allow you to stand clear of the wire rope when the winch is under load.
- ▲ **Universal Flat Bed Mounting Plate:** Your winch is being supplied with a flat bed mounting plate that can be mounted to most flat surfaces such as trailers, step bumpers, truck beds, etc. The mounting plate also has holes to accept your roller fairlead.

Included With Your Winch

1. Winch Assembly with Wire Rope	1
2. Mounting Plate	1
3. Roller Fairlead	1
4. Motor & Battery Cables	4
5. Clevis Hook	1
6. Cable Stopper	1
7. Rocker Switch & Mounting Bracket	1
8. Solenoid & "Y" Cable	1
9 Remote Control	1
10.Remote Control Socket	1
11.Non-marring Strap	1
12.Cable Ties	1
13.Mounting Hardware	1

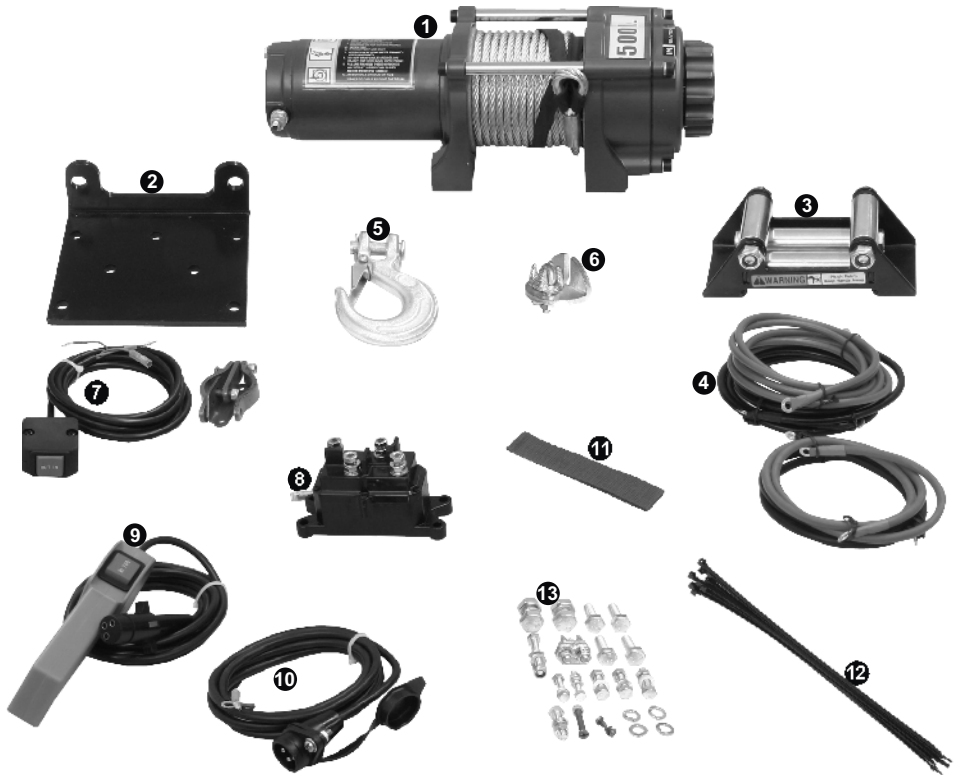

Accessories You Will Need (not included with your winch)

- ▲ **Gloves** – For handling the wire rope and hook strap.
- ▲ **Anchor Strap/Chain** – Tree saver anchor straps are made of high quality nylon with high tensile strengths from 5,000lbs to 10,000lbs.
- ▲ **Heavy Blanket** – place on the cable to absorb energy should the wire rope break.

Winch Assembly And Mounting

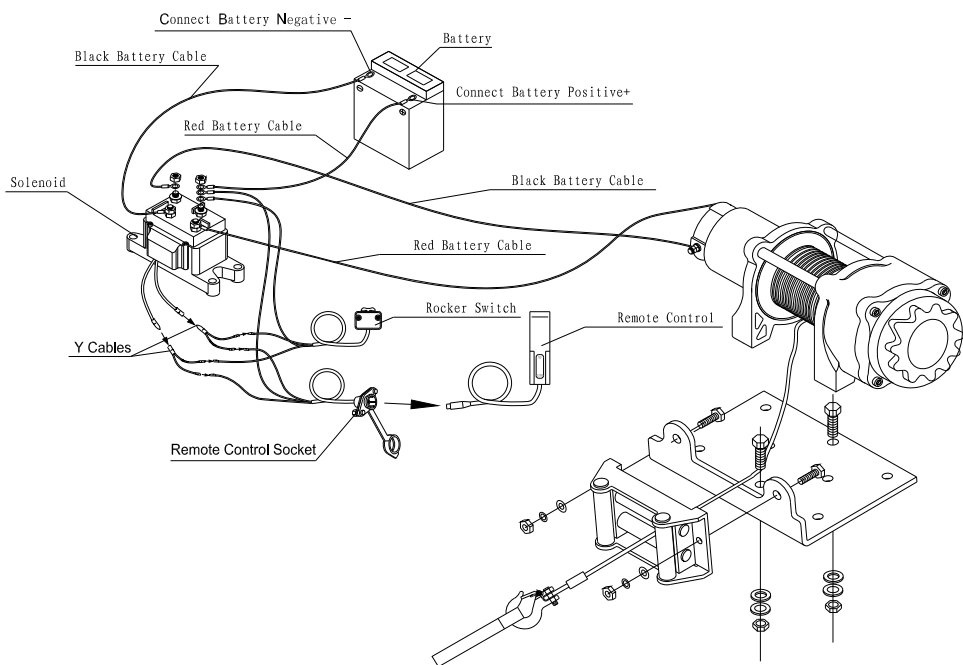

Remote Control Socket Mounting

Nut and Lock washer

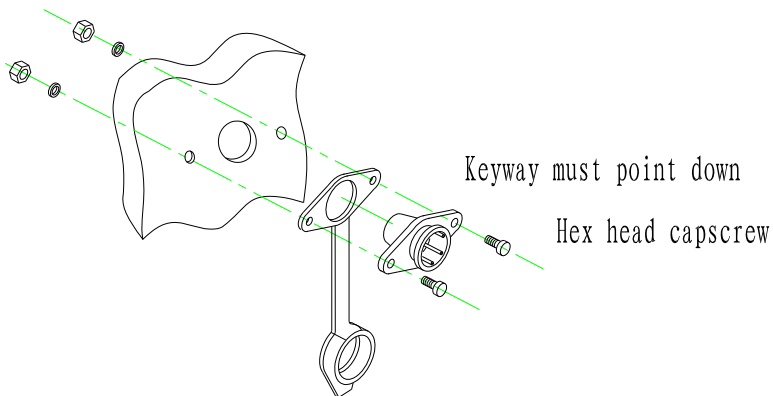

- ▲ Your 3500lb winch is designed with a bolt pattern that is standard in this class of winch. Many winch mounting kits are available that utilize this bolt pattern for the most popular ATV's and mounting plates. It is not guaranteed that this plate will fit onto your particular ATV/UTV. Check with your reseller for a more accurate fitting mounting plate. If you will utilize the mounting plate you must ensure that it is mounted on a flat surface so that the three major sections (motor, drum and gear housing) are properly aligned. Proper alignment of the winch will allow even distribution of the full rated load.
- ▲ Start by connecting the roller fairlead (part #3) to the mounting plate (part #2) using 2 each of the cap screw m8 x 20, flat washer, lock washer and securing with a nut m8 (make sure the screw is placed through the mounting plate and roller fairlead from inside the plate. this will allow enough clearance for the winch to be placed in the plate without obstruction.)
- ▲ Assemble the winch to the mounting plate (part #2) by first pulling and releasing the clutch knob to "off" position (free spooling). pull out a few inches of cable from the drum and feed the wire loop through the opening in the front of the mounting plate and roller fairlead. Now, using the remaining m8 x 15 cap screws and lock washers secure the winch to the mounting plate.
- ▲ Connect the battery and motor leads as the previous drawing.
- ▲  CAUTION – Batteries contain gases which are flammable and explosive. Wear eye protection during installation and remove all jewelry. Do not lean over battery while making connections.
- ▲ Assemble the clevis hook to the cable. take off the pin from the clevis hook, connect the clevis hook to the cable and mount the pin back to the clevis hook.
- ▲ Always use the Hand Saver when free-spooling and re-spooling the wire rope. Using the Hand Saver keeps your hands and fingers away from the rotating drum.
- ▲ Check for proper drum rotation. Pull and turn the clutch knob to the "off" position (Free-spooling). Pull out some cable from the drum, and then turn the clutch knob to the "In" position to engage the gears. Press the cable out button on the power switch. If the drum is turning and releasing more cable then your connections are accurate. If the drum is turning and collecting more cable then reverse the leads on the motor. Repeat and check rotation.

Rigging Techniques (Self Recovery)

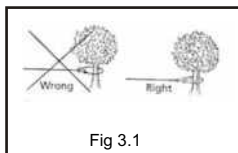

Locate a suitable anchor such as a strong tree trunk or boulder. Always use a sling as an anchor point.

⚠ CAUTION Do not attach the clevis hook back onto the cable as this could cause damage to the cable. As shown in Fig 3.1

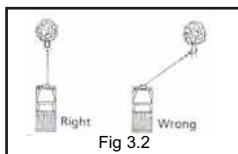

Do not winch from an acute angle as the wire rope will pile up on one side of the drum causing damage to wire rope and the winch. Fig 3.2

Short pulls from an angle can be used to straighten the vehicle. Long pulls should be done with the wire rope at a 90° angle to the winch/vehicle.

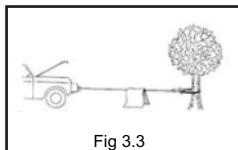

When pulling a heavy load, place a blanket or jacket over the wire rope five or six feet from the hook. In the event of a broken cable it will dampen the snap back. For additional protection open the hood of the vehicle as shown in Fig 3.3

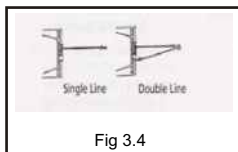

For pulls over 1800lbs, we recommend the use of the snatch lock/pulley block to double line the wire rope. Fig 3.4 This reduces the load on the winch and the strain on the rope by approximately 50%.



⚠ WARNING - Never use your winch for overhead hoisting or for lifting people or moving people

Winching Techniques A-Z

- A.** Take time to assess your situation and plan your pull.
- B.** Put on gloves to protect your hands.
- C.** Disengage the clutch to allow free-spooling and also save battery power.
- D.** Attach the hand saver hook to the clevis hook.
- E.** Pull out the wire rope to your desired anchor point using the hand saver hook.
- F.** Secure the clevis hook to the anchor point: Sling, chain or snatch block. Do not attach the hook back onto the wire rope.
- G.** Engage the clutch.
- H.** Connect the remote control to the winch.
- I.** Start your engine to ensure power is being replenished to the battery.
- J.** Power in the wire rope guiding the wire under tension to draw up the slack in the wire. Once the wire is under tension stand well clear. Never step over the wire rope.
- K.** Double check your anchors and make sure all connections are secure.
- L.** Inspect the wire rope. Make sure there are at least 5 wraps of wire rope around the winch drum.
- M.** Drape a blanket or jacket over the wire rope approximately 5 to 6 feet from the hook. Open the hood for added protection.
- N.** Clear the area. Make sure all spectators all well back and that no one is directly in front or behind the vehicle or anchor point.
- O.** Begin winching. Be sure that the wire rope is winding evenly and tightly around the drum. The vehicle that is being winched can be slowly driven to add assistance to the winching process. Avoid shock loads; keep the wire rope under tension.

Winching Techniques A-Z (ctd.)

- P.** The vehicle to be winched should be placed in neutral and the emergency brake released. Only release the brake pedal when under full tension. Avoid shock loads to the winch. This can damage the winch, rope and vehicle.
- Q.** The winch is meant for intermittent use. Under full load with a single line rig do not power in for more than a minute without letting the motor cool down for a few minutes and then resume the winching operation.
- R.** The winching operation is complete once the vehicle is on stable ground and is able to drive under its own power.
- S.** Secure the vehicle. Be sure to set the brakes and place the vehicle in park.
- T.** Release the tension on the wire rope. The winch is not meant to hold the vehicle for long periods of time.
- U.** Disconnect the wire rope from the anchor.
- V.** Rewind the wire rope. Make sure that any wire already on the drum has spooled tightly and neatly. If not, draw out the wire and re-spool from the point where the rope is tight.
- W.** Keep your hands clear of the winch drum and fairlead as the wire rope is being drawn in.
- X.** Secure the hook and hook strap.
- Y.** Disconnect the remote control and store in a clean, dry place.
- Z.** Clean and inspect connections and mounting hardware for next winching operation.



ATTENTION



The Manufacturer is not responsible for damages caused by an improper and unforeseen use of the machine.

The Manufacturer is not responsible for:

- ▲ Improper use of the machine, use by untrained staff;
- ▲ Serious deficiencies in the foreseen maintenance;
- ▲ Changes or not allowed modifications;
- ▲ Use of non-original or specified spare parts;
- ▲ Failure to fully or partially comply with the instructions;
- ▲ Failure to comply with the common safety rules during work;
- ▲ Unusual cases.

Maintenance

- ▲ Periodically check the tightness of mounting bolts and electrical connections. Remove all dirt or corrosion and always keep clean.
- ▲ Do not attempt to disassemble the gear box. Repairs should be done by the manufacturer or an authorized repair center.
- ▲ The gear box has been lubricated using a high temperature lithium grease and is sealed at the factory. No internal lubrication is required.

Replacing The Wire Rope

- ▲ If the wire rope has become worn or is beginning to show signs of strands breaking, it must be replaced before being used again. To do this, remove the defective rope by free spooling. Remove the screw M5x8 on the drum and release the rope.
- ▲ Insert the end of the new rope and secure the screw M5 x 8 tightly.
- ▲ Engage the clutch and re-spool the new rope on the drum keeping tension on the rope as it spools. Ensure that the rope is re-spooling in the under wind position.



WARNING



Replace the wire rope only with identical replacement parts recommended by the manufacturer

Trouble Shooting

SYMPTOM	POSSIBLE CAUSE	SUGGESTED ACTION
Motor does not turn on	<ul style="list-style-type: none"> ▲ Switch Assembly not connected properly ▲ Loose battery cable connections ▲ Defective Switch Assembly ▲ Defective motor ▲ Water has entered motor 	<ul style="list-style-type: none"> ▲ Insert Switch Assembly all the way into the connector. ▲ Tighten nuts on all cable connections. ▲ Replace Switch Assembly. ▲ Check for voltage at armature port with Switch pressed. If voltage is present, replace motor. ▲ Allow to drain and dry. Run in short bursts without load until completely dry.
Motor runs but cable drum does not turn	<ul style="list-style-type: none"> ▲ Clutch not engaged 	<ul style="list-style-type: none"> ▲ Turn clutch to the "In" position. If problem persists, a qualified technician needs to check and repair.
Motor runs slowly or without normal power	<ul style="list-style-type: none"> ▲ Insufficient current or voltage 	<ul style="list-style-type: none"> ▲ Battery weak, recharge. Run winch with vehicle motor running. ▲ Loose or corroded battery cable connections. Clean, tighten, or replace.
Motor overheating	<ul style="list-style-type: none"> ▲ -Winch running time too long 	<ul style="list-style-type: none"> ▲ Allow winch to cool down periodically.
Motor runs in one direction only	<ul style="list-style-type: none"> ▲ Defective Switch Assembly 	<ul style="list-style-type: none"> ▲ Loose or corroded battery cable or motor cable connections. Clean and tighten. ▲ Repair or replace switch assembly.

Winch Assembly Drawing (3500lbs)

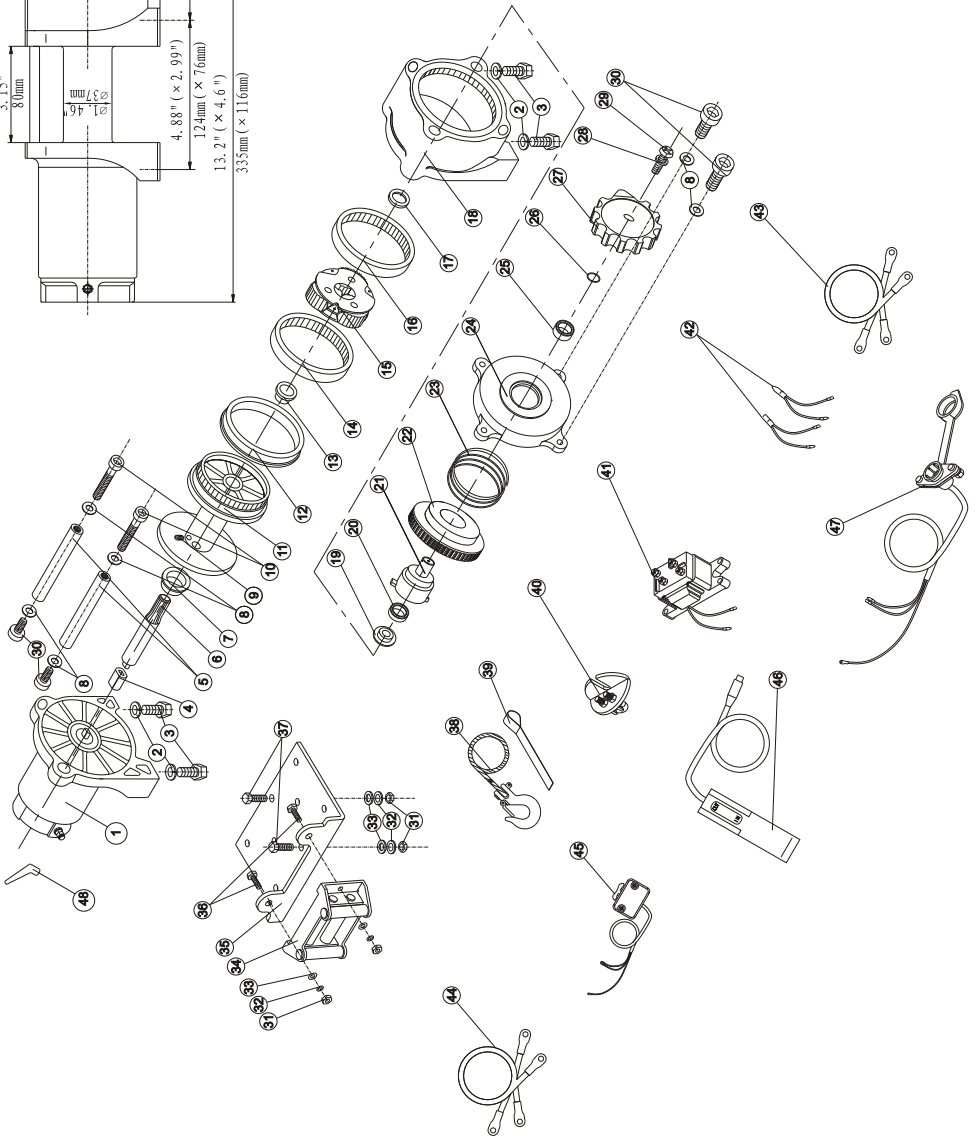
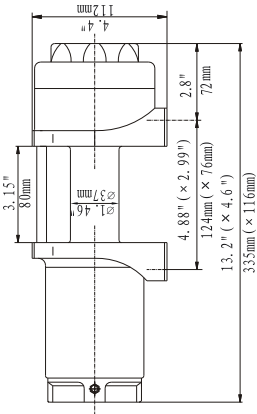

Winch Parts List (3500lbs)

No.	Part #	Qty	Description	Remark
1	P250100	1	Motor Assembly	
2	P250001	4	Locking Washer $\Phi 8$	
3	P250002	4	Cap Screw M8 x 15	
4	P250003	1	Transition Shaft	
5	P250004	2	Tie Bar	
6	P250005	1	Hexagonal Shaft	
7	P250006	1	Front Bush Drum	
8	P250007	6	Spring Washer $\Phi 6$	
9	P250008	1	Screw M5 x 8	
10	P250009	2	Cap Screw M6 x 65	
11	P250010	1	Drum	
12	P250011	1	Rear Bush Drum	
13	P250012	1	Front Thrust Washer	
14	P250013	1	Gear Ring Output	
15	P250200	1	Gear Carrier Assembly	
16	P250014	1	Gear Ring	
17	P250015	1	Thrust Washer	
18	P250016	1	Gear Housing / End Bearing	
19	P250017	1	Bearing Holder	
20	P250018	1	Roller Bearing	
21	P250019	1	Clutch axes	
22	P250020	1	Cam Clutch Gear	
23	P250021	1	Spring	
24	P250022	1	Cover Clutch Housing	
25	P250023	1	Roller Bearing	
26	P250024	1	Elastic Collar	
27	P250025	1	Clutch Handle	
28	P250026	1	Locking Washer $\Phi 5$	
29	P250027	1	Cap Screw M5 x 12	
30	P250028	4	Cap Screw M6 x 20	
31	P250029	4	Hex Flange Nut M8	
32	P250030	4	Locking Washer $\Phi 8$	
33	P250031	4	Thick Flat Washer $\Phi 8$	
34	P250300	1	Roller Fairlead	
35	P250032	1	Mounting Plate	
36	P250033	2	Cap Screw M8 x 20	
37	P250034	2	Cap Screw M8 x35	
38	P250400	1	Cable Assembly	
39	P250035	1	Non-marring Strap	
40	P250500	1	Cable Stopper	
41	P250600	1	Solenoid	
42	P250700	1	Y Cable	
43	P250800	1	Battery Cables	
44	P250900	1	Motor Cables	
45	P251000	1	Rocker Switch	
46	P251100	1	Remote Control (RC4)	
47	P251200	1	Remote Control Socket	
48	P250036	2	Terminal Protector	

Specifications

Rated line pull	3500 lbs (1588 kgs)
Motor: permanent magnet	1.3hp/1.0kw(DC 12V)
Gear reduction ratio	170:1
Cable (Dia. × L)	Ø7/32" × 42'
Drum size (Dia. × L)	Ø1.46" × 3.15"
Mounting bolt pattern	3.13" (79.5 mm) 4-M8
Overall dimensions (L × W × H)	13.2" × 4.6" × 4.4"
Net weight lbs(kg)	23(10.4)

Pull, Speed, Amperes, Volts (First layer):

Line Pull lbs (kgS)	Line Speed ft/min (m/min)		Current A	
	12V DC	24V DC	12V DC	24V DC
0	10.5(3.2)	10.5(3.2)	20	16
1000(454)	9.0(2.7)	9.5(2.9)	75	40
2000(907)	7.7(2.3)	8.9(2.7)	130	75
3500(1588)	4.6(1.4)	7.7(2.3)	200	120

Line Pull And Rope Capacity In Layer

Layer	Rated line pull lbs (kgs)	Total rope on the drum ft (m)
1	3500(1588)	6.0(1.8)
2	2789(1265)	13.6(4.1)
3	2319(1052)	22.1(6.7)
4	1984(900)	31.2(9.5)
5	1733(786)	42.0(12.8)

Komodo 3500lbs ATV/UTV Winch Limited Warranty

KOMODO., ("Distributor") warrants its **3500lbs ATV/UTV Winch** (the "Products") as follows:

1. **Limited Warranty.**

Distributor warrants to original purchaser, providing **Proof of Purchase**, that the Products sold hereunder will be free from defects in material and workmanship for a period of **one year** from date of purchase. If the products do not conform to this Limited Warranty during the warranty period (as herein specified), Buyer shall notify Distributor, in writing, within the warranty period, and the defects are of such type and nature as to be covered by this warranty, Distributor shall, at its own expense, furnish replacement products or, at Distributor's option, replacement parts for the defective products. Shipping and installation of the replacement Products or replacement parts shall be at Buyer's expense.

2. **Other Limits.**

THE FOREGOING IS IN LIEU OF ALL OTHER WARRANTIES, EXPRESS OR IMPLIED, INCLUDING BUT NOT LIMITED TO THE IMPLIED WARRANTIES OF MERCHANTABILITY AND FITNESS FOR A PARTICULAR PURPOSE. Distributor does not warrant against damages or defects arising out of improper or abnormal use or handling of the Products; against defects or damages arising from improper installation, against defects in products or components. Distributor passes on to Buyer the warranty received (if any) from the maker thereof of such Manufacturer made products or components. This warranty also does not apply to Products upon which repairs have been affected or attempted by persons other than pursuant to written authorization by Distributor. Fasteners are not covered in this warranty.

3. **Exclusive Obligation.**

THIS WARRANTY IS EXCLUSIVE. The sole and exclusive obligation of Distributor shall be to repair or replace the defective Products in the manner and for the period provided above. Distributor shall not have any other obligation with respect to the Products or any part thereof, whether based on contract, tort, strict liability, or otherwise. Under no circumstances, whether based on this Limited Warranty or otherwise, shall Distributor be liable for incidental, special, or consequential damages.

4. **Other Statements.**

Distributor's employees or representatives' ORAL OR OTHER WRITTEN STATEMENTS DO NOT CONSTITUTE WARRANTIES, and shall not be relied upon by Buyer, and are not a part of the contract for sale or this Limited Warranty.

5. **Entire Obligation.**

This Limited Warranty states the entire obligation of Distributor with respect to the Products. If any part of this

Item # EW3500DLX
Purchase Date: _____
Retailer's Name: _____

Notes

KOMODO ATV Accessories
1311 John Reed Ct.
City of Industry, CA 91745 USA
1(800)333-8889

Other Komodo ATV products

Be sure to ask your retailer for more Komodo ATV Accessories to fit your needs.

3-Way ATV Hitch



ATV Bucket/Grate Carrier



2pc ATV Basket Set



ATV Multi-fit Carrier



ATV Deep Basket



ATV Drag Harrow



UTV Cab Rack



UTV Roof Rack Carrier



ATV Flip Single Bucket Carrier



ATV Adj. Platform Carrier



ATV Universal Wheel Chock

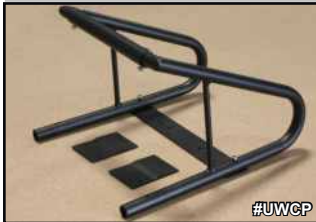

Portable Winch Mount



UTV Side Cargo Box



UTV Bed Extender



More To Come

We at Komodo are constantly looking for new ideas to make your ATV/UTV use experience easier. Expect more great products from us in a near future.

KOMODO ATV Accessories

1311 John Reed Ct.
City of Industry, CA 91745 USA
1(800)333-8889

